

CLOSING THE RECYCLING LOOP



MSD

Copy Paper

Recycling conserves energy and natural resources as well as landfill space. Pollution from resource extraction, power production, manufacturing and waste disposal are likewise reduced. Collecting and sorting wastes for recycling is useless without demand for products made from recycled materials.

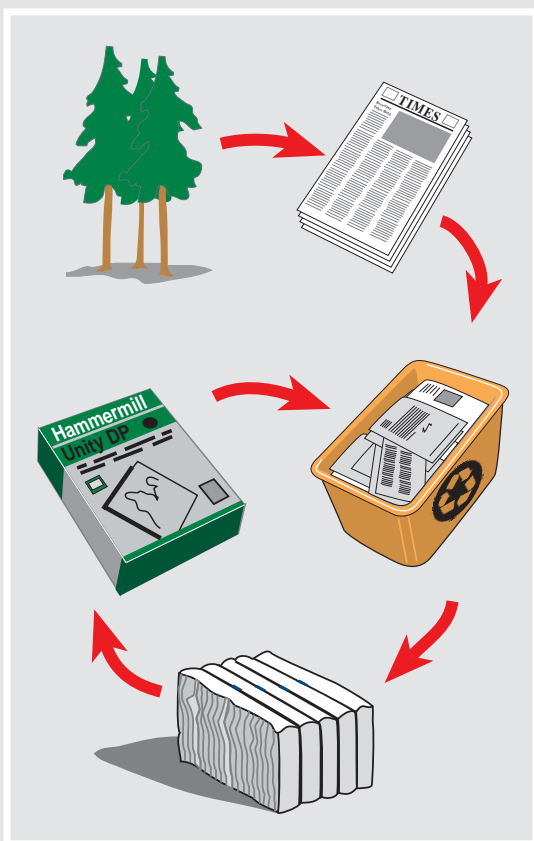

Recycled Paper Features

- MSD uses Hammermill's Unity® DP copy paper. It's 100% recycled newspaper and magazines, half of which are post-consumer.
- "Post-consumer" refers to paper bought by a consumer, used and returned for recycling via an office, curbside collection or drop-off program.
- This paper is unbleached. Other office paper is still bleached with chlorine, which generates a very toxic by-product called dioxin. Dioxin has been linked to cancer and birth defects.
- Unbleached paper is slightly tinted. Because it produces less glare under office lights, it's easier on user's eyes.
- Unbleached paper improves two-sided copying by reducing show-through.

Anticipated Savings

MSD's use of 100% recycled paper spares 500 trees from the ax annually.

The recycled paper costs essentially the same as traditional copy papers.

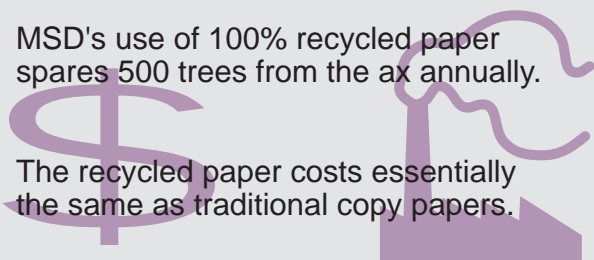

WASTE WISE

